

DESIGN DESIGNATION

A.A.D.T. - 2025 = 8200
 A.A.D.T. - 2035 = 9100
 D.H.V. = 910
 T = 8%
 V = 35 & 55 M.P.H.
 D = 50%

FUNCTIONAL CLASSIFICATION-MAJOR COLLECTOR

NO R/W ACQUISITION

MISSOURI HIGHWAYS AND TRANSPORTATION COMMISSION

PLANS FOR PROPOSED STATE HIGHWAY

CASS / JOHNSON COUNTY



KEY MAP
 LOCATION OF CASS AND JOHNSON COUNTY



INDEX OF SHEETS

| DESCRIPTION | SHEET NUMBER |
|------------------------------------|--------------|
| TITLE SHEET | 1 |
| TYPICAL SECTIONS (TS) (2 SHEETS)-- | 2 |
| QUANTITIES (QU) (2 SHEETS)----- | 3 |
| SPECIAL SHEETS (SS)----- | 4-5 |
| TRAFFIC CONTROL SHEETS (TC)----- | 6-10 |

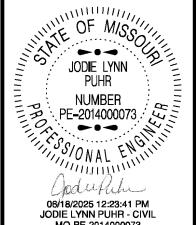

| | |
|----------------------------------|-----------------------|
| DATE PREPARED 6/2/2025 | |
| ROUTE 2 | STATE MO |
| DISTRICT KC | SHEET NO. 1 |
| COUNTY CASS / JOHNSON | |
| JOB NO. JKU0049 | |
| CONTRACT ID. | |
| PROJECT NO. | |
| BRIDGE NO. | |

CONVENTIONAL SYMBOLS
 (USED IN PLANS)

| | EXISTING | NEW |
|------------------------------|----------|-----|
| BUILDINGS AND STRUCTURES | | |
| GUARD RAIL | | |
| GUARD CABLE | | |
| CONCRETE RIGHT-OF-WAY MARKER | | |
| STEEL RIGHT-OF-WAY MARKER | | |
| LOCATION SURVEY MARKER | | |
| UTILITIES | | |
| FIBER OPTICS | -FO- | FO |
| OVERHEAD CABLE TV | -OTV- | OTV |
| UNDERGROUND CABLE TV | -UTV- | UTV |
| OVERHEAD TELEPHONE | -OT- | OT |
| UNDERGROUND TELEPHONE | -UT- | UT |
| OVERHEAD POWER | -OE- | OE |
| UNDERGROUND POWER | -UE- | UE |
| SANITARY SEWER | -S- | S |
| STORM SEWER | -SS- | SS |
| GAS | -G- | G |
| WATER | -W- | W |
| MANHOLE | | |
| FIRE HYDRANT | | |
| WATER VALVE | | |
| WATER METER | | |
| DROP INLET | | |
| DITCH BLOCK | | |
| GROUND MOUNTED SIGN | | |
| LIGHT POLE | | |
| H-FRAME POWER POLE | | |
| TELEPHONE PEDESTAL | | |
| FENCE | | |
| CHAIN LINK | | |
| WOVEN WIRE | | |
| GATE POST | | |
| BENCHMARK | | |

NOTE: DASHED OR OPEN SYMBOLS INDICATE EXISTING FEATURES

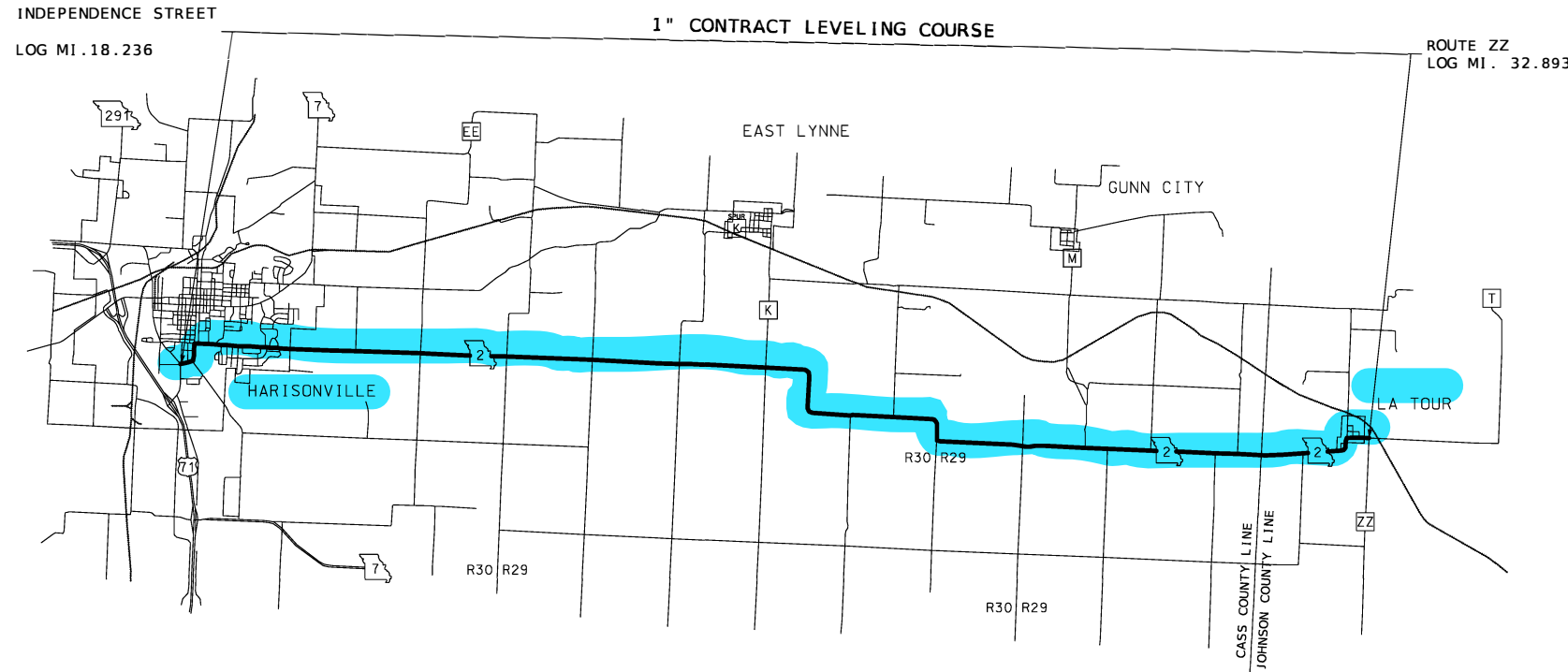

NOT TO SCALE

LENGTH OF PROJECT

| | |
|---|--------------|
| BEGINNING OF PROJECT | 18.236 MI. |
| END OF PROJECT | 32.893 MI. |
| APPARENT LENGTH | 77,389 FEET |
| EQUATIONS AND EXCEPTIONS: | |
| TOTAL CORRECTIONS | 77,389 FEET |
| NET LENGTH OF PROJECT | 77,389 FEET |
| STATE LENGTH | 14.657 MILES |
| FOR INFORMATION ONLY ESTIMATED DISTURBED ACRES | 0 ACRES |

THE EXISTENCE AND APPROXIMATE LOCATION OF UTILITY FACILITIES KNOWN TO EXIST, AS SHOWN ON THE PLANS, ARE BASED ON THE BEST INFORMATION AVAILABLE TO THE COMMISSION AT THIS TIME. THIS INFORMATION IS PROVIDED BY THE COMMISSION "AS-IS" AND THE COMMISSION EXPRESSLY DISCLAIMS ANY REPRESENTATION OR WARRANTY AS TO THE COMPLETENESS, ACCURACY, OR SUITABILITY OF THE INFORMATION FOR ANY USE. RELIANCE UPON THIS INFORMATION IS DONE AT THE RISK AND PERIL OF THE USER, AND THE COMMISSION SHALL NOT BE LIABLE FOR ANY DAMAGES THAT MAY ARISE FROM ANY ERROR IN THE INFORMATION. IT IS, THEREFORE, THE RESPONSIBILITY OF THE CONTRACTOR TO VERIFY THE EXISTENCE, LOCATION AND STATUS OF ANY FACILITY. SUCH VERIFICATION INCLUDES DIRECT CONTACT WITH THE LISTED UTILITIES.

DESCRIPTION

DATE

MISSOURI HIGHWAYS AND TRANSPORTATION COMMISSION

105 WEST CAPITOL
 JEFFERSON CITY, MO 65102
 1-888-ASK-MODOT (1-888-275-6636)

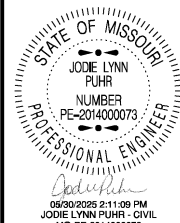

DATE PREPARED
5/23/2025
ROUTE 2 STATE MO
DISTRICT KC SHEET NO. 2
COUNTY CASS / JOHNSON
JOB NO. JKU0049
CONTRACT ID.
PROJECT NO.
BRIDGE NO.

| | |
|--|---------------------------|
| BITUMINOUS PAVEMENT MIXTURE PG 64-22 (SURFACE LEVELING) | 1.975 TON/YD ³ |
| TACK COAT - EXISTING | .08 GAL/YD ² |
| PERMANENT AGGREGATE EDGE TREATMENT | 2 TONS/CY |

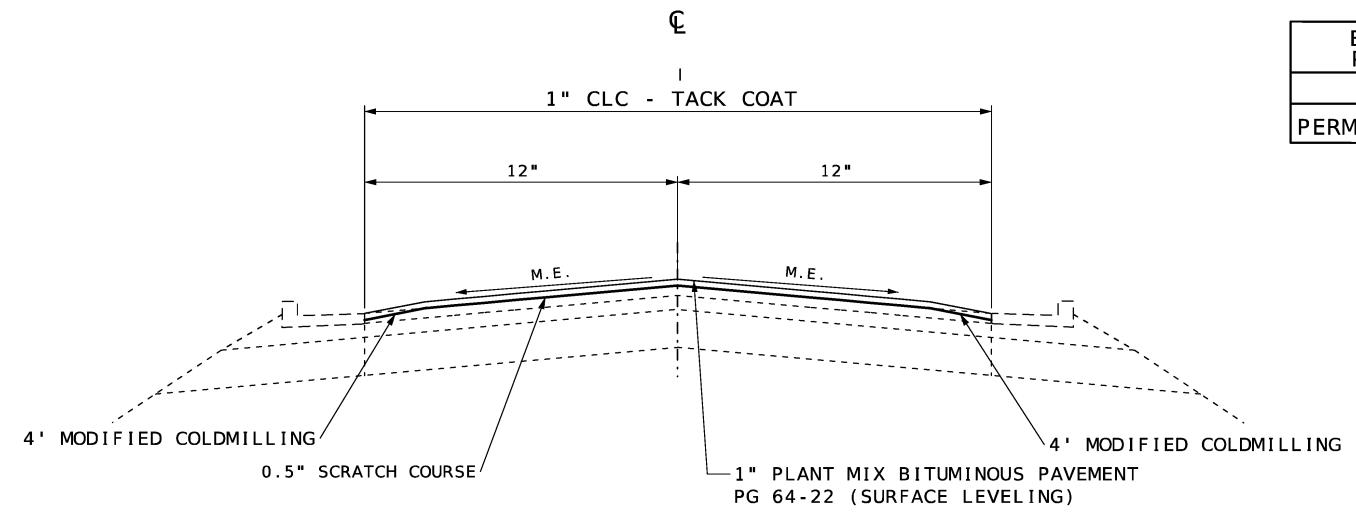

LOG MI. 18.236 - LOG MI. 18.273
LOG MI. 18.437 - LOG MI. 18.580

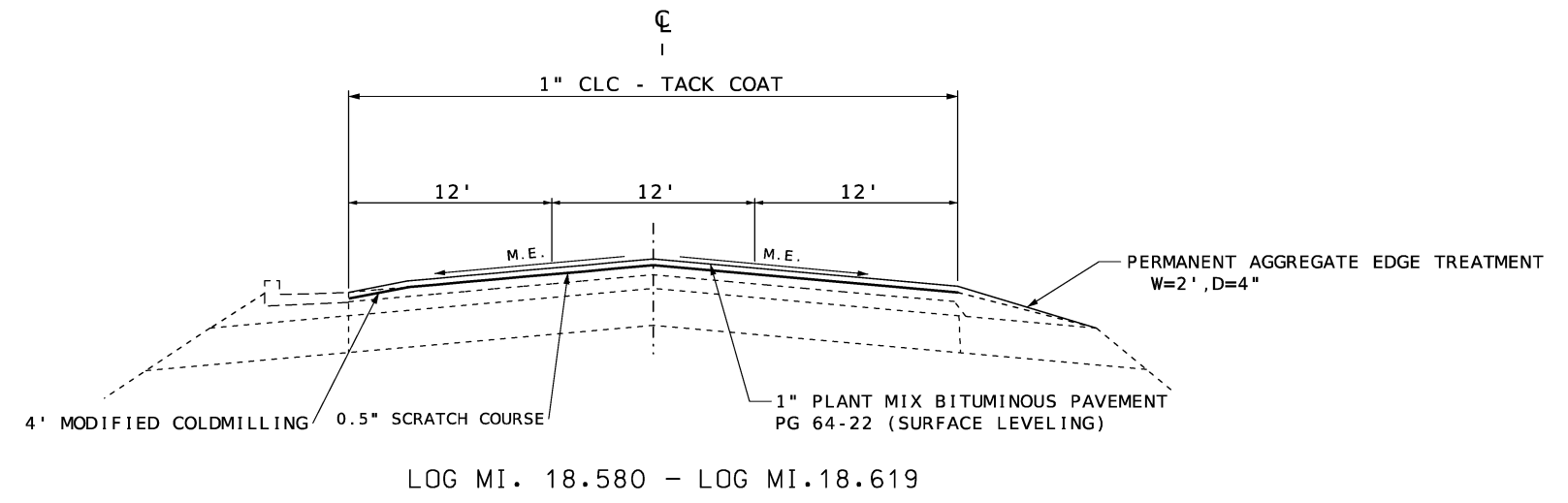
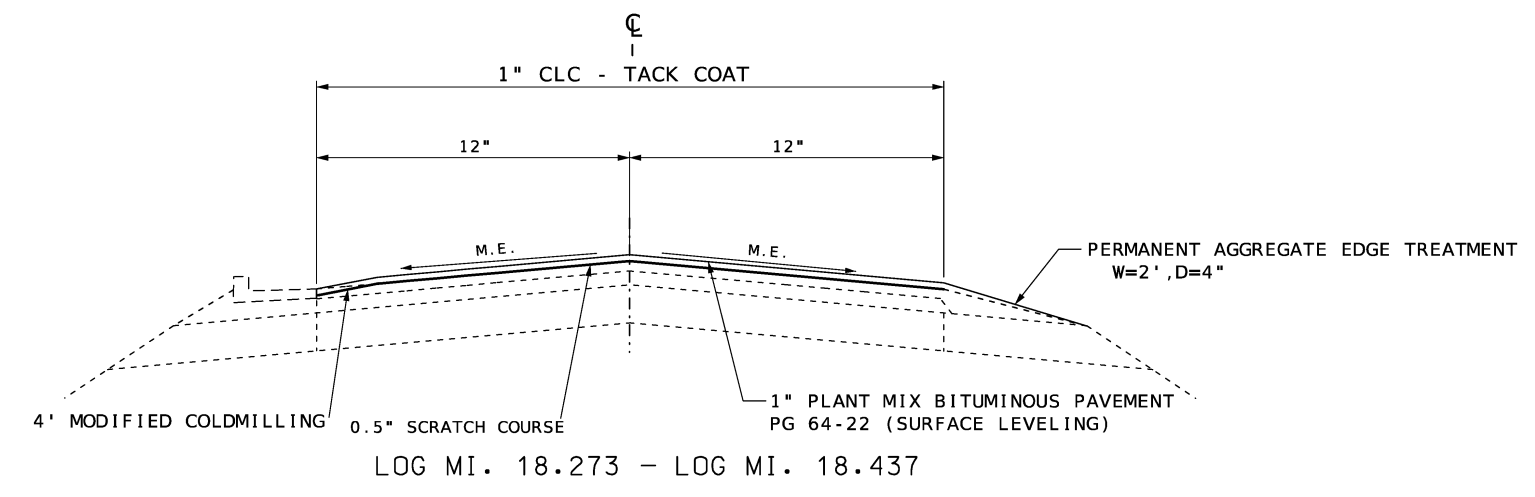

| DATE | DESCRIPTION |
|------|-------------|
| | |
| | |
| | |
| | |
| | |
| | |
| | |
| | |
| | |
| | |

MISSOURI HIGHWAYS AND TRANSPORTATION
COMMISSION

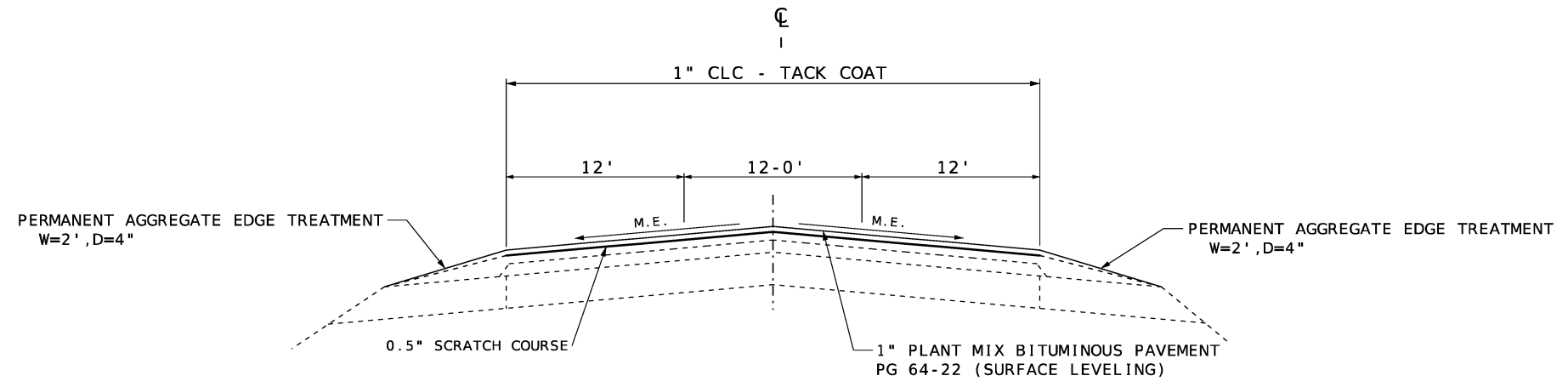
105 WEST CAPITOL
JEFFERSON CITY, MO 65102
1-888-ASK-MODOT (1-888-275-6636)

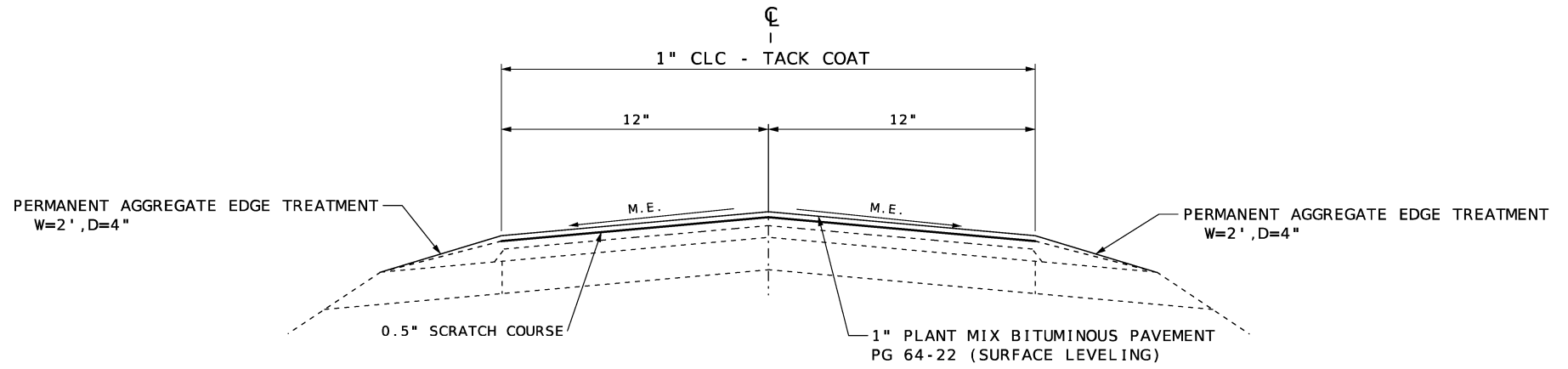

LOG MI. 18.619 - LOG MI. 18.635

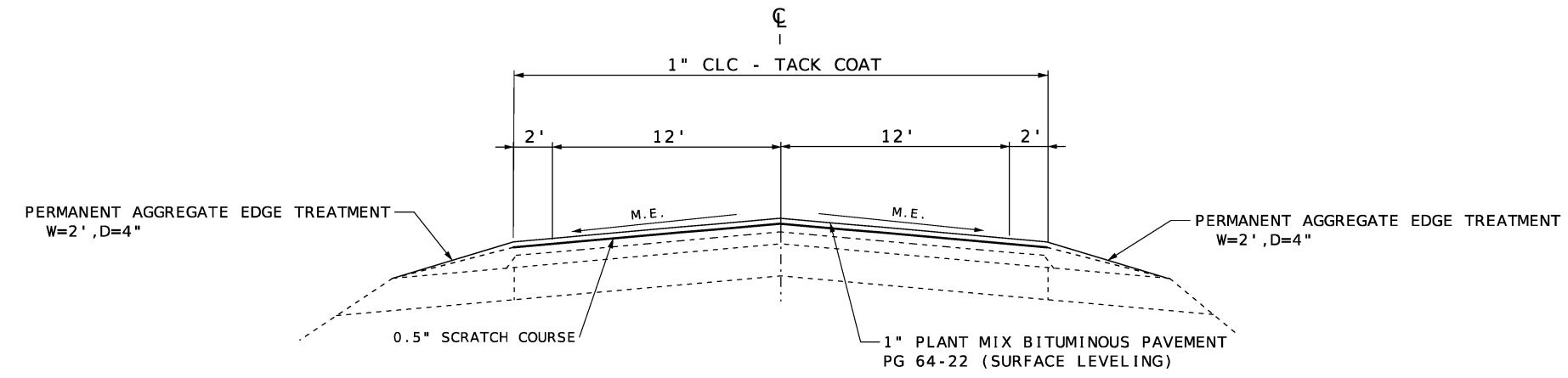

LOG MI. 18.635 - LOG MI. 19.627



LOG MI. 19.627 - LOG MI. 32.893

TYPICAL SHEET
SHEET 2 OF 2

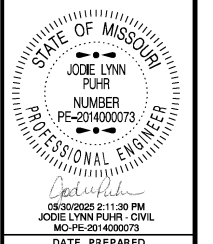

| | |
|----------------------------|----------------|
| DATE PREPARED 5/23/2025 | |
| ROUTE 2 | STATE MO |
| DISTRICT KC | SHEET NO. 2 |
| COUNTY CASS / JOHNSON | |
| JOB NO. | |
| CONTRACT ID. | |
| PROJECT NO. JKU0049 | |
| BRIDGE NO. | |

| DATE | DESCRIPTION |
|------|-------------|
| | |
| | |
| | |
| | |
| | |
| | |
| | |
| | |
| | |
| | |

MISSOURI HIGHWAYS AND TRANSPORTATION COMMISSION

105 WEST CAPITOL
JEFFERSON CITY, MO 65102
1-888-ASK-MODOT (1-888-275-6636)

| |
|--------------|
| MOBILIZATION |
| 1 LUMP SUM |

| MODIFIED COLDMILLING | | | | |
|----------------------|----------|----------|-------------------------|--|
| ROUTE | LOG MILE | LOG MILE | MODIFIED COLDMILLING SY | REMARKS |
| 2 | 18.236 | 18.273 | 174 | BOTH SIDE CURB |
| 2 | 18.236 | 18.243 | 64 | START OF PROJECT (TL ONTO S INDEPENDENCE ST) |
| 2 | 18.239 | 18.243 | 127 | START OF PROJECT (S INDEPENDENCE ST) |
| 2 | 18.273 | 18.437 | 385 | LS CURB |
| 2 | 18.437 | 18.580 | 671 | BOTH SIDE CURB |
| 2 | 18.580 | 18.619 | 92 | LS CURB |
| 2 | 18.586 | 18.596 | 139 | W SOUTH ST |
| 2 | 18.598 | 18.598 | 24 | S INDEPENDENCE ST |
| 2 | 32.884 | 32.893 | 103 | END OF PROJECT |
| 2 | 18.236 | 32.893 | 220 | 19 CONCRETE ENTRANCES |
| PAY TOTAL | | | 1999 | |

| PAVEMENT TREATMENT | | | | | | | | | |
|--------------------|----------|----------|----------|-------------------------|---------------------|-------------------------|--|-----------|---------------------------------|
| LOG MILE | LOG MILE | LOCATION | LENGTH | AVERAGE TRAVELWAY WIDTH | 0.5" SCRATCH COURSE | 1" BIT SURFACE LEVELING | PERMANENT AGGREGATE EDGE TREATMENT (INCL. ENTRANCES) | TACK COAT | REMARKS |
| | | | FT | FT | TONS | TONS | TONS | GAL | |
| 18.236 | 18.273 | ROUTE 2 | 195.36 | 24 | 14.3 | 28.6 | 0 | 84 | BOTH SIDE CURB |
| 18.273 | 18.437 | ROUTE 2 | 865.92 | 24 | 63.3 | 126.7 | 43 | 370 | ONE SIDE CURB |
| 18.437 | 18.580 | ROUTE 2 | 755.04 | 24 | 55.2 | 110.5 | 0 | 322 | BOTH SIDE CURB |
| 18.580 | 18.619 | ROUTE 2 | 205.92 | 36 | 22.6 | 45.2 | 10 | 132 | ONE SIDE CURB |
| 18.619 | 18.635 | ROUTE 3 | 84.48 | 30 | 7.7 | 15.4 | 8 | 46 | TURN LANE TAPER |
| 18.635 | 19.627 | ROUTE 2 | 5237.76 | 24 | 383.1 | 766.3 | 518 | 2234 | |
| 19.627 | 32.893 | ROUTE 2 | 70044.48 | 28 | 5977.6 | 11955.1 | 6918 | 34866 | START OF SHOULDERS |
| | | | | | | 31.7 | | 46 | 50 ASPHALT ENTRANCES/CROSSROADS |
| | | | | | | 3261.95 | | | 25% IRREGULARITIES |
| SUB TOTAL | | | | | 6523.8 | 16341.5 | 7497 | 38100 | |
| PAY TOTAL | | | | | 22865.3 | | 7497 | 38100 | |

| CLASS 1 PAVEMENT MARKING PAINT (18-MIL, TYPE P BEADS) | | | | | |
|---|--------|--------|-------------------|--------------------|---------------------------|
| ROUTE | LOG MI | LOG MI | 4" WHITE SOLID LF | 4" YELLOW SOLID LF | 4" YELLOW INTERMEDIATE LF |
| 2 | 18.236 | 32.893 | 154873 | 89749 | 12345 |
| PAY TOTAL | | | 154873 | 102094 | |

| CONSTRUCTION SIGNING | | | | | | |
|------------------------------------|---------|------------|--------------------------|------|--------------------------------|--------------------------------------|
| SIGN NO. | SIGN | SIZE (in.) | AREA (ft. ²) | QTY. | TOTAL AREA (ft. ²) | DESCRIPTION |
| ① * | GO20-1 | 60 x 24 | 10.00 | 2 | 20 | ROAD WORK NEXT 15 MILES ① 2-15 MILES |
| ② ** | WO20-1 | 48 x 48 | 16.00 | 22 | 352 | ROAD WORK AHEAD |
| ⑦ | WO20-4 | 48 x 48 | 16.00 | 6 | 96 | ONE LANE ROAD AHEAD |
| ⑧ | WO20-7a | 48 x 48 | 16.00 | 22 | 352 | FLAGGER (SYMBOL) |
| ⑪ | WO3-4 | 48 x 48 | 16.00 | 18 | 288 | BE PREPARED TO STOP |
| ⑳ | GO20-2 | 48 x 24 | 8.00 | 2 | 16 | END ROAD WORK |
| ㉓ | WO8-12 | 48 x 48 | 16.00 | 15 | 240 | NO CENTER LINE |
| ㉖ | WO8-11 | 48 x 48 | 16.00 | 30 | 480 | UNEVEN LANES |
| ㉙ | GO20-4 | 36 x 18 | 4.5 | 1 | 4.5 | PILOT CAR FOLLOW ME |
| ㉚ | GO20-4a | 42 x 30 | 8.75 | 4 | 35 | PILOT CAR IN USE WAIT & FOLLOW |
| ㉛ | GO20-4a | 18 x 12 | 1.50 | 18 | 27 | PILOT CAR IN USE WAIT & FOLLOW |
| ㉜ | CONST-8 | 48 x 36 | 12.00 | 2 | 24 | WORK ZONE NO PHONE ZONE |
| | GO22-1 | 21 X 15 | 2.19 | 4 | 8.76 | WET PAINT (ARROW PIVOTS) |
| 616-10.05 CONSTRUCTION SIGNS TOTAL | | | | | 1943 | |

| PAVEMENT MARKING - PREFORMED THERMOPLASTIC PAVEMENT MARKING | | | | | |
|---|-----------------|-----------------------------|--------------------|--|----------------------------|
| ROUTE | LOG MILE WB | 24" WHITE SOLID STOP BAR LF | LT / RT ARROW EACH | 30" WHITE MIDBLOCK CROSSWALK (ZEBRA) EACH (6' x 30") | REMARKS |
| 2 | 18.576 | 24 | | 9 | W SOUTH ST |
| 2 | 18.593 - 18.594 | 12 | | 6 | S INDEPENDENCE ST (MO -2) |
| 2 | 18.601 | 12 | | 6 | S INDEPENDENCE ST |
| 2 | 18.605 | 24 | 1 | 11 | MO-2 WB TURN LANE |
| 2 | 18.874 | | | 4 | CROSSWALK BY EASTWOOD RD |
| 2 | 19.398 | | | 4 | CROSSWALK AT BIRD AVE |
| PAY TOTAL | | 72 | 1 | 40 | |

| ITEM NO. | QTY. | DESCRIPTION |
|-----------|------|--------------------------|
| 616-10.25 | 550 | CHANNELIZERS (TRIM-LINE) |

| WATER VALVE AND MANHOLE HEIGHT ADJUSTMENT | | | |
|---|----------|------------------------------|---------------|
| LOG MILE | LOG MILE | WATER VALVE AND MANHOLE EACH | REMARKS |
| 18.236 | 19.718 | 6 | HARRISONVILLE |

NOTE:
REFER TO STANDARD PLANS 616.10 AND 903.03 FOR SIGN AND SIGN MOUNTING REQUIREMENTS.
* IF LESS THAN TWO (2) MILES, DELETE SIGN NO. 1.
** ADDITIONAL SIGN NO. 2 USED AS SHOWN ON TRAFFIC CONTROL SHEET 3 OF 5 AND AS DIRECTED BY THE ENGINEER.

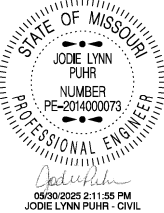

DATE PREPARED
5/23/2025

ROUTE 2 STATE MO
DISTRICT KC SHEET NO. 3

COUNTY CASS / JOHNSON
JOB NO. JKU0049
CONTRACT ID.

PROJECT NO.
BRIDGE NO.

DESCRIPTION
DATE

MISSOURI HIGHWAYS AND TRANSPORTATION COMMISSION



105 WEST CAPITOL
JEFFERSON CITY, MO 65102
1-888-ASK-MODOT (1-888-275-6636)

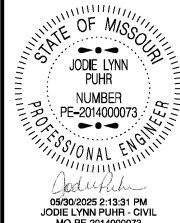

DATE PREPARED
5/23/2025

| | |
|--------------------------|----------------|
| ROUTE 2 | STATE MO |
| DISTRICT KC | SHEET NO. 6 |
| COUNTY CASS / JOHNSON | |
| JOB NO. JKU0049 | |
| CONTRACT ID. | |
| PROJECT NO. | |
| BRIDGE NO. | |

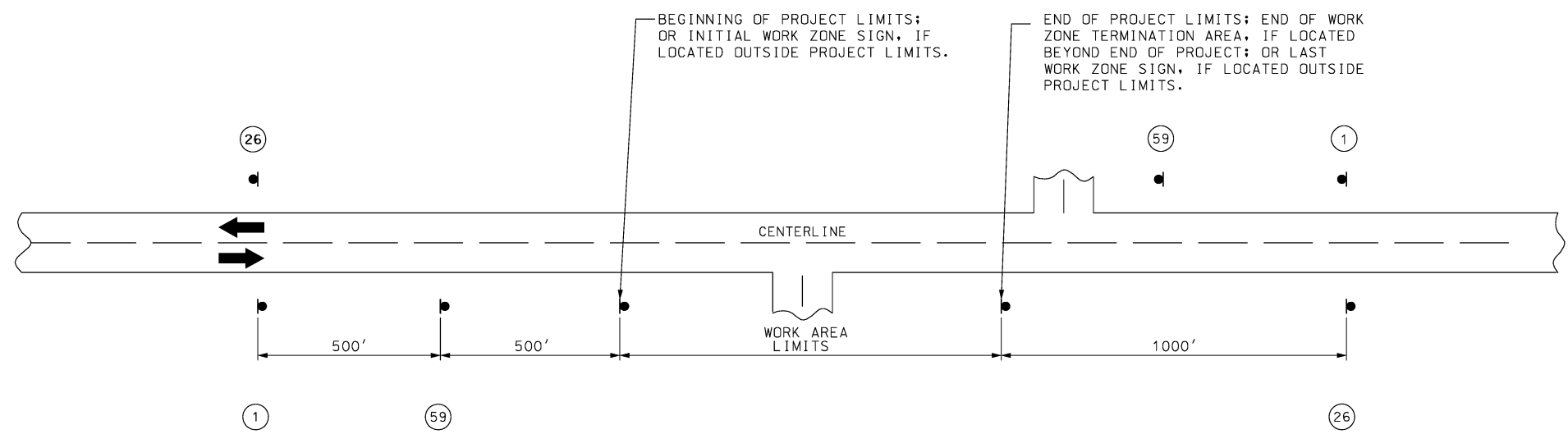

NOTES:

SIGN ① AND ②⑥ ARE ONLY USED ON PROJECT LENGTHS 2 MILES OR GREATER.

PROVIDE SIGNS IN EACH DIRECTION ON TWO-WAY HIGHWAY.

DISTANCE MAY BE ADJUSTED ACCORDING TO FIELD CONDITIONS.

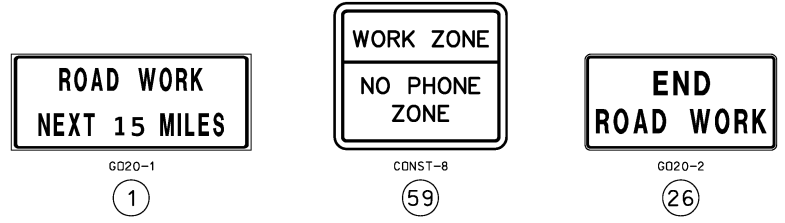

| DATE | DESCRIPTION |
|------|-------------|
| | |
| | |
| | |
| | |
| | |
| | |
| | |
| | |
| | |
| | |

MISSOURI HIGHWAYS AND TRANSPORTATION COMMISSION

105 WEST CAPITOL
JEFFERSON CITY, MO 65102
1-888-ASK-MODOT (1-888-275-6636)



W020-1
2



W020-4
7



W020-7a
8



G020-4
53

SIGN 53, "PILOT CAR FOLLOW ME" SHALL BE THE CONTRACTOR'S RESPONSIBILITY WHEN IN USE DURING OPERATION.

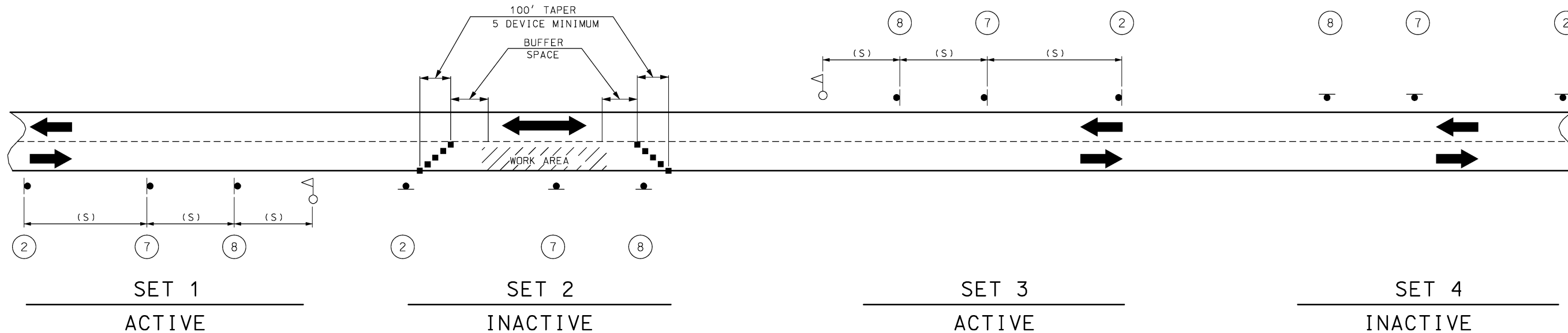

NOTES:

DAYLIGHT FLAGGING OPERATIONS ONLY.

CHANNELIZING DEVICES LOCATED DOWNSTREAM OF THE ONE-LANE, TWO-WAY TAPER ARE OPTIONAL. THESE DEVICES SHOULD BE ELIMINATED WHEN THEIR USE WILL REDUCE THE USABLE LANE WIDTH, INCLUDING ANY ACCEPTABLE SHOULDERS, TO LESS THAN 10' OR WILL SIGNIFICANTLY AFFECT THE RESURFACING OPERATION.

SIGN SETS 1 AND 3 ARE ACTIVE AND (I.E., SIGNS FACE ONCOMING TRAFFIC) SIGN SETS 2 AND 4 ARE INACTIVE (I.E., SIGNS DO NOT FACE EITHER DIRECTION OF TRAFFIC) WHEN THE RESURFACING OPERATION IS LOCATED BETWEEN SIGN SETS 1 AND 3.

WHEN SIGN SETS 2 AND 4 ARE ACTIVE, SIGN SETS 1 AND 3 BECOME INACTIVE AND ARE ADVANCED TO BECOME SETS 2 AND 4 WITH SIGN LEGENDS TURNED AWAY FROM BOTH DIRECTIONS OF TRAFFIC. WHEN THE RESURFACING OPERATION ADVANCES TO BETWEEN SIGN SETS 2 AND 4, SIGN SETS 2 AND 4 BECOME ACTIVE (I.E., NEW SIGN SETS 1 AND 3) AND SIGN SETS 1 AND 3 ADVANCED IN THE DIRECTION OF THE OPERATION (I.E., NEW SIGN SETS 2 AND 4).

■ - CHANNELIZERS

○ - FLAGGER

(1) SPACING BETWEEN SIGNS, BETWEEN LAST SIGN AND FLAGGER, BEGINNING OF TAPER OR SIGNED CONDITION.

SPACING MAY BE ADJUSTED AS NECESSARY TO MEET FIELD CONDITIONS.

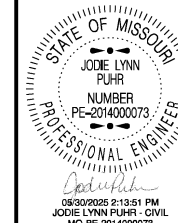

DATE PREPARED

5/23/2025

ROUTE 2 STATE MO

DISTRICT KC SHEET NO. 7

COUNTY CASS / JOHNSON

JOB NO. JKU0049

CONTRACT ID.

PROJECT NO.

BRIDGE NO.

DESCRIPTION

DATE

MISSOURI HIGHWAYS AND TRANSPORTATION COMMISSION



105 WEST CAPITOL
JEFFERSON CITY, MO 65102
1-888-ASK-MODOT (1-888-275-6636)

| SPEED | SIGN SPACING (FT) (1) | CHANNELIZER SPACING (FT) |
|------------------------|--------------------------|--------------------------|
| PERMANENT POSTED (MPH) | NON-DIVIDED HIGHWAYS (S) | BUFFER/WORK AREA (TYP.) |
| 0-35 | 200 | 40 |
| 40-45 | 350 | 80 |
| 50-55 | 500 | 80 |
| 60-70 | 1000 | 120 |

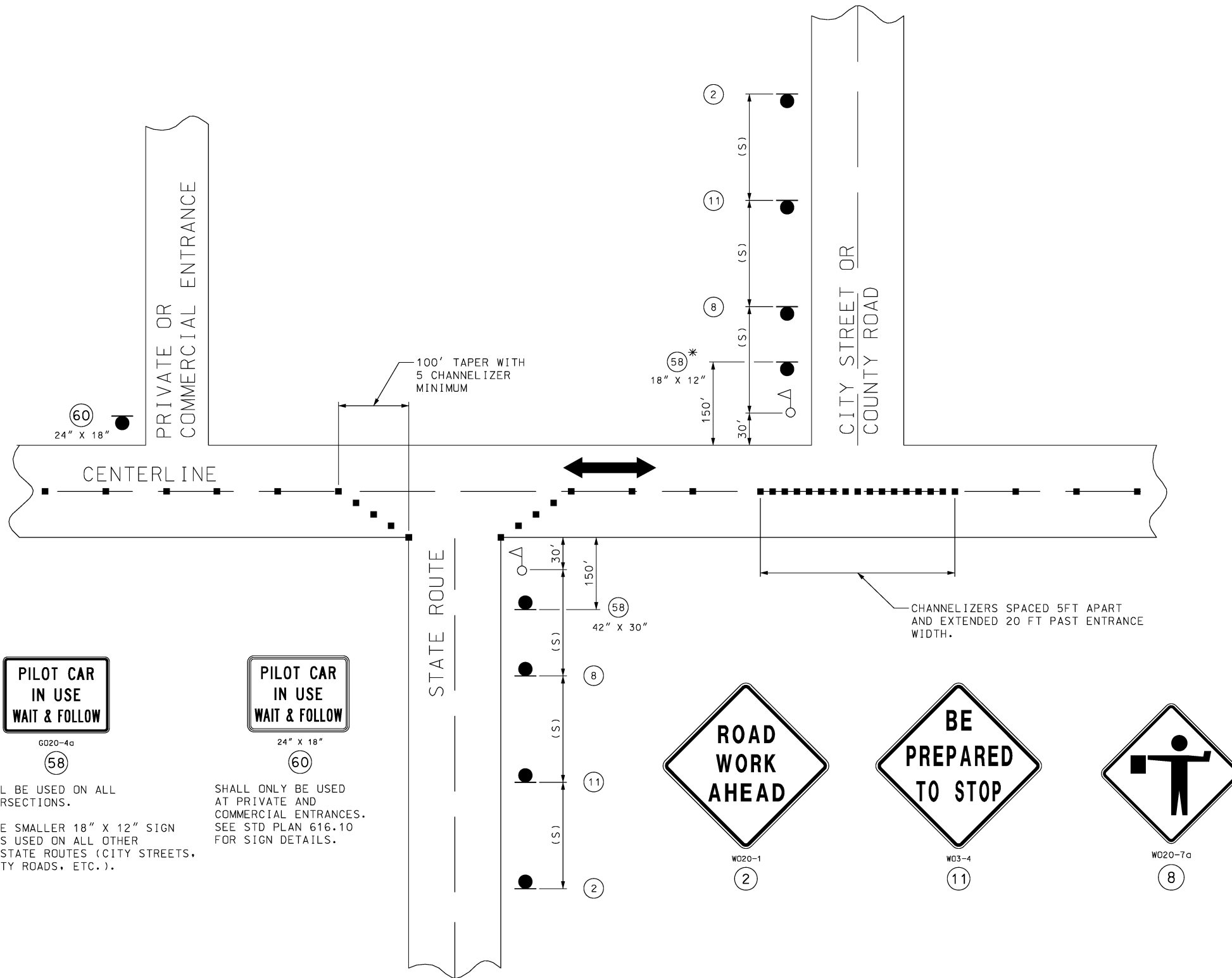

(1) SPACING BETWEEN SIGNS, BETWEEN LAST SIGN AND FLAGGER, BEGINNING OF TAPER OR SIGNED CONDITION.

SPACING MAY BE ADJUSTED AS NECESSARY TO MEET FIELD CONDITIONS.

NOTES:
 WARNING SIGNS SHALL BE ERECTED AT EACH INTERSECTION WITH ANOTHER STATE HIGHWAY WITHIN THE WORK ZONE.

ADDITIONAL WARNING SIGNS SHALL BE ERECTED AT OTHER INTERSECTIONS WITHIN THE WORK ZONE, AS DIRECTED BY THE ENGINEER.

- - CHANNELIZERS (AS SPECIFIED)
- △ - FLAGGER

NOT TO SCALE

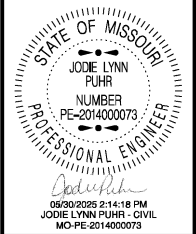

DATE PREPARED
5/23/2025

ROUTE **2** STATE **MO**

DISTRICT **KC** SHEET NO. **8**

COUNTY
CASS / JOHNSON

JOB NO.
JKU0049

CONTRACT ID.

PROJECT NO.

BRIDGE NO.

| DATE | DESCRIPTION |
|------|-------------|
| | |
| | |
| | |
| | |
| | |
| | |
| | |
| | |
| | |
| | |

MISSOURI HIGHWAYS AND TRANSPORTATION COMMISSION

MoDOT

105 WEST CAPITOL
 JEFFERSON CITY, MO 65102
 1-888-ASK-MODOT (1-888-275-6636)

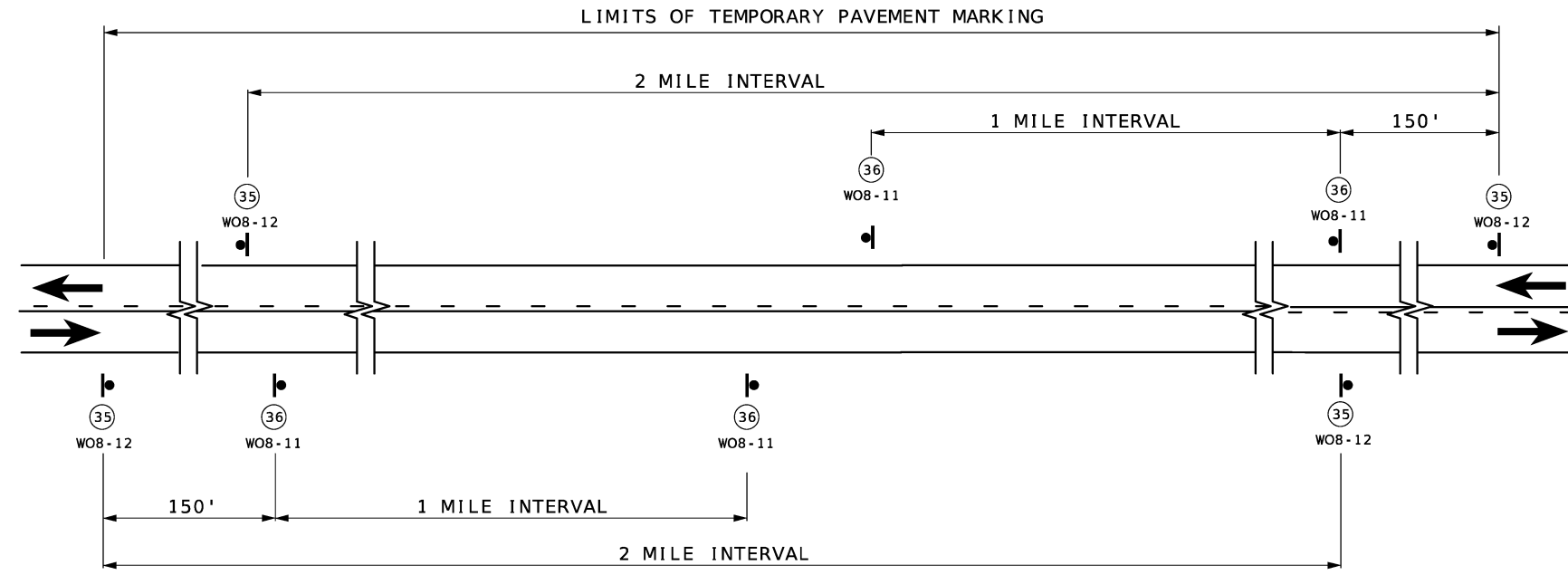

SIGN SPACING AND TEMPORARY STRIPING FOR MAINLINE

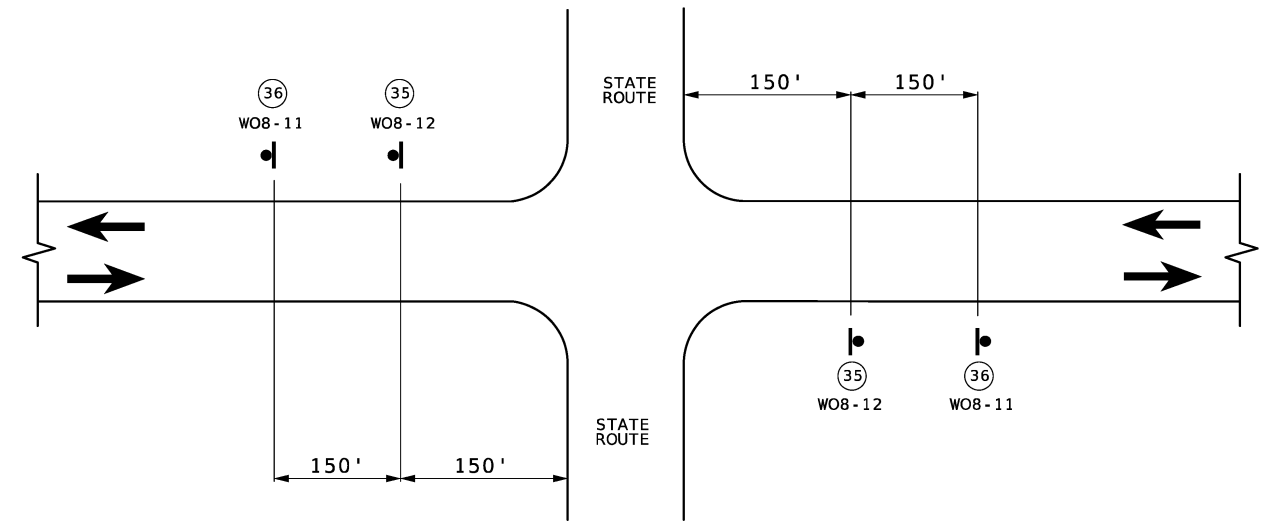

SIGN SPACING AT STATE ROUTE INTERSECTIONS SHOWING TEMPORARY STRIPING FOR MAINLINE

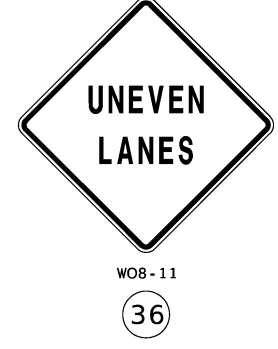
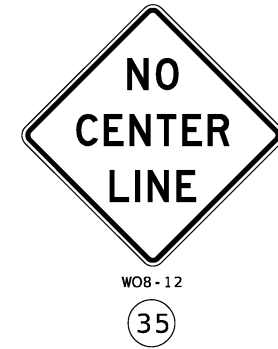

NOTES:

SIGN (35) AND TEMPORARY RAISED PAVEMENT MARKING (SEE STANDARD PLAN 620.10) INSTALLED WHERE CENTERLINE STRIPING HAS BEEN COVERED OR REMOVED. SIGNS ARE TO REMAIN IN PLACE UNTIL THE PERMANENT CENTERLINE PAVEMENT MARKINGS ARE IN PLACE. SIGNS SHALL BE COVERED OR REMOVED WHEN PAVEMENT CENTERLINE MARKING HAS BEEN INSTALLED.

SIGN (35) IS PLACED AT APPROXIMATELY TWO-MILE INTERVALS AND AT STATE ROUTE JUNCTIONS. WHEN THE INSTALLATION AT A JUNCTION IS WITHIN ONE-EIGHTH MILE OF THE NORMAL MAINLINE SIGN (35), THE LATTER MAY BE ELIMINATED.

ALL SIGNS SHALL BE POST MOUNTED AND IN ACCORDANCE WITH STANDARD PLAN 616.10 AND 903.03.

NOT TO SCALE

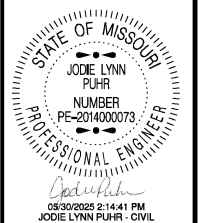

DATE PREPARED
5/23/2025

ROUTE 2 STATE MO
DISTRICT KC SHEET NO. 9

COUNTY CASS / JOHNSON
JOB NO. JKU0049
CONTRACT ID.

PROJECT NO.
BRIDGE NO.

| DESCRIPTION | DATE |
|-------------|------|
| | |
| | |
| | |
| | |
| | |
| | |
| | |
| | |
| | |

MISSOURI HIGHWAYS AND TRANSPORTATION COMMISSION
105 WEST CAPITOL JEFFERSON CITY, MO 65102
1-888-ASK-MODOT (1-888-275-6636)



